



Luxury Boutique Cruises  
*Vietnam - Cambodia - Myanmar*

# MYANMAR

IN SEARCH OF THE EXCEPTIONAL



A Heritage Line Collection  
Jayavarman • jasmine • violet • THE JAHAN • Anawrahta

[www.heritage-line.com](http://www.heritage-line.com)



## •• HERITAGE LINE ••

Heritage Line, a consummate collector designs ships to re-create the past and glory of an era gone-by. Each vessel is distinctive in its décor and setting. Each detail painstakingly crafted, to remake history. Authenticity, tradition, art and exploration lie at the heart of our compilation of the exclusive. Vessels with their own tales to tell.



### Anawrahta A GREAT KING

King Anawrahta was born in 1014. His mother was Myaunk Pynthe and his father, King Kuhshaw Kyaunghpyu was once the ruler of Pagan. His father was overthrown by his stepbrothers, Kyiso and Sokkate. Anawrahta upon coming of age and learning the betrayal of his father, challenged Sokkate to a duel and won, bringing back the crown to their family.

King Anawrahta made Pagan the capital city of Burma, modern day Myanmar, he described it as the "city of a thousand temples" because of the numerous structures, temples and pagodas built around the city.

King Anawrahta converted to Theravada Buddhism, the oldest and most traditional school of Buddhism that focuses on "the teaching of the Elders."

Blending the purity and serenity of King Anawrahta's Buddhist beliefs with the opulence of the British Empire, The Anawrahta is the perfect vessel on which to explore Myanmar's mighty Ayeyarwady River. Built to resemble a British colonial paddle steamer, the elegant 65-meter/ 214 feet long Anawrahta features three spacious decks and 23 luxurious cabins. With its gleaming white rails, polished lacquer, intricately carved woodwork and all furniture is hand-made in Myanmar using recycled teak, The Anawrahta takes guests back in time to an era of bygone elegance.



# Anawrahta

## Technical Figures



# Anawrahta

## Decks

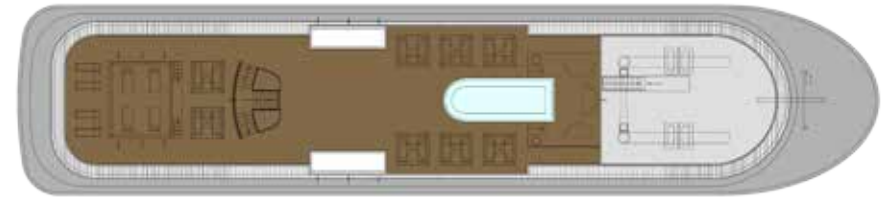

SUN DECK

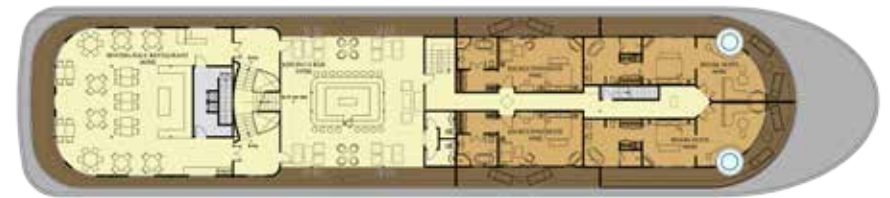

TERRACE DECK



UPPER DECK



MAIN DECK

- Length: 65 meters / 213 feet
- Beam: 14 meters / 45 feet
- Draft: 0.9 meters / 3 feet
- Gross Tonnage: 650 tons
- Cruising speed: 12 knots
- Electricity: 220 Volts
- Engines: 2 Caterpillar
- Generators: 3 Caterpillar
- Water: Reverse osmosis plant with UV filtration and ozone treatment
- AC: Centralized air-conditioning system throughout the vessel, individual control in each cabin
- Safety: International safety standard, including smoke and fire alarm system throughout the ship, emergency lighting systems, emergency communication system, evacuation equipment, Defibrillator (AED) on board
- Crew: 46 crew members (including Cruise manager and English speaking guides)
- Accommodation: 46 Passengers



# Anawrahta

## At A Glance

With just twenty-three artfully designed cabins, the Anawrahta offers plenty of space to unwind. Exclusive, yet friendly, we have the highest crew to passenger ratio on the Ayeyarwady. Whether guests wish to enjoy private moments or socialize, the boat has a variety of memorable venues from which to enjoy and explore this unique river.

### ••• Kipling's Bar

Set on the Terrace Deck, the Kipling's Bar is the perfect place to watch the world slip by as you enjoy your favorite wine or cocktail. With its high ceilings, large windows and colonial-style rattan chairs, Kipling's Bar invites guests to relax and contemplate the passing river life. With colors inspired by local spices, the Kipling's Bar is a spacious 157-square meters/ 1,690-square feet..



### ••• Mandalay Lounge

With polished wood floors, comfortable rattan chairs and traditional Burmese decorations, the 162-square meter/ 1,744-square feet Mandalay Lounge has the relaxed feel of a colonial club, at once exclusive and welcoming. Lean back against the burnt-orange cushions and enjoy a good book, or join friends for a nightcap in the lounge's elegant and exotic ambiance. This elegant venue is located on the Upper Deck.



### ••• Hintha Hall Restaurant

Inspired by the lavish decorations of old Bagan and Mandalay, the Anawrahta's Hintha Hall Restaurant evokes the elegant dining halls of yesteryear. White tablecloths and gleaming glassware are surrounded by polished wood, intricately designed floor and ceiling panels and - last but not least - stunning views, framed by large picture windows. With seating for 48, the 141-square meter/ 1,518-square feet Hintha Hall lies on the Terrace Deck.



### ••• Thazin Spa

The Anawrahta is especially proud of its spa, which offers expert service, locally-inspired treatments and beautiful surroundings. Inspired by Mandalay's White Hsinbyume Pagoda, the Thazin Spa features three massage beds, manicure and pedicure stations and a Swedish-style-sauna. Superbly trained staff and inspiring views make this the ultimate place to unwind.





## Anawrahta Staterooms

Enjoy the comforts you'd expect in a fine resort on land with a waterfront view that's constantly changing. When building the Anawrahta, we sourced materials, handicrafts and fine arts from the best artisans and artists throughout the country. The private staterooms and public venues showcase the talent of local artists, many of whom employ traditional skills passed down for generations.

### ••• Deluxe & Deluxe Executive

The Anawrahta's ten beautifully appointed Deluxe and six Deluxe Executive staterooms, all with private balcony, are decorated with original handicrafts, locally-carved wood panels and richly-textured fabrics inspired by the brocade of Burma's ethnic minority groups. Large windows and serene colors inspire total relaxation. The Deluxe Executive sit on the upper deck while the Deluxe are located on the main deck.

*Size: 32 square meters with private balcony*



### ••• Junior Suites

Named after some of the most fascinating rivers in Myanmar, the Anawrahta offers three Junior Suites: the Kaladan, the Lenya and the Thandi. Combining dark, regal wood with the bright oranges, saffrons and greens of the floral offerings presented at temples, these suites offer a comfortable seating area and a private balcony from which to enjoy the lush beauty of the Ayeyarwady.

*Size: 48 square meters with private balcony*

### • Executive Suites

Located on the Terrace Deck, each of our two Executive Suites has spacious 59 square meters, including an indoor seating area and a private balcony. Polished wood, locally made brocade and artefacts collected in Mandalay, Bagan and Yangon create a relaxing yet exotic ambiance. These suites are named after Myanmar's famous rivers, the Chindwin and the Yangon.

*Size: 59 square meters including 16.5 square meters balcony space.*



### • Royal Suites

The two opulent Royal Suites are named after Anawrahta and his son Kyansitta, considered as two of the most famous monarchs in Burmese history. Equipped with a private terrace and a private Jacuzzi, these stunning suites feature elaborate woodcarvings, fine works of Burmese art, and handmade artefacts commissioned throughout Burma.

*Size: 86 square meters, including a terrace of 29 square meters with a private Jacuzzi*





# Anawrahta

## Life On Board

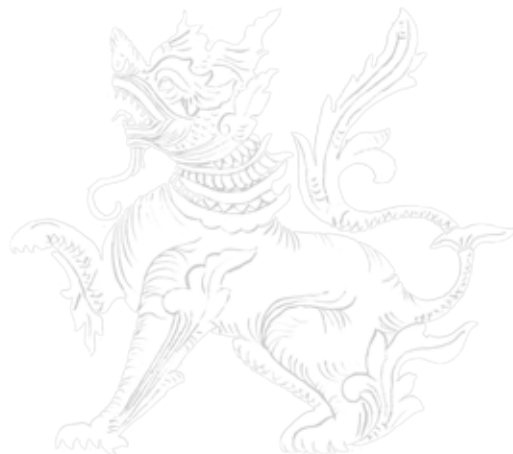

• While the Anawrahta is the perfect stage, the star of the show is the river. Rising early, you make your way to the sun deck, just as the first rays of gold touch the surface of the Ayeyarwady. A fisherman casts his net, throwing shimmering droplets into the morning light. After enjoying this unforgettable view - and a strong coffee - you are ready to join an open-air yoga class or meditation session.

You pass all manner of other craft, from simple fishing canoes to boats crowded with fresh produce, household goods, giggling school children. Villagers come out to wave. Water buffaloes watch you warily. You keep a lookout for the river's most famous residents, the Ayeyarwady dolphins.

When it's time for lunch you join your fellow guests in the Hintha Hall dining room, where

waiters - who now greet you like an old friend - serve tantalizing dishes from throughout Burma. As you learn about the complex cuisine, you understand more about this nation's cultural diversity.

Sunset finds you and your friends in the Kipling's Bar enjoying freshly-made cocktails - and freshly inspiring views. As the river turns from blue to violet, you understand Rudyard Kipling's long-ago nostalgia: "If you've 'eard the East a-callin', you won't never 'need naught else."



### Local Flavors. Fresh, diverse and delicious

As well as offering international favourites, the Anawrahta's chefs take great pride in introducing their guests to the authentic flavours of Burma. Influenced by the cuisines of China, Thailand and India, Burmese food is as diverse as it is delectable. Thanks to its long coastline, seafood plays a prominent role, as do fresh herbs, aromatic spices and both highland and lowland vegetables. A typical Burmese meal involves steamed rice, a fish or meat curry and a light soup. Salads, known as a thoke, are plentiful, as are imaginative condiments. Last but not least, the nation's Buddhist culture has given rise to mouth-watering vegetarian options.





# Anawrahta

## Journeys

### •• Ancient Capitals & Golden Land Voyage

5 days, 4 night | 4 days, 3 nights | 3 days, 2 nights

A classic cruise with variable choices of length between Mandalay and Bagan or vice versa on the Ayeyarwady River. Cruises run all year around and highlight the cultural center of this amazing country.

### •• Impressive Gorges 8 days, 7 nights

A voyage to the north of Myanmar on the Ayeyarwady River. Wonderful scenic and full of history and local life.

### •• Exotic Chindwin 12 days, 11 nights

A longer expedition cruise to very remote and quaint regions of the North East of Myanmar. For guests who looking getting the "off-the-beaten-track" adventure.



## MYANMAR

IN SEARCH OF THE EXCEPTIONAL

The person in charge of publication:  
 Director - Editor-in-chief NGUYEN THI THANH HUONG  
 Editor: Dao Thuy Ngan  
 Lay-outter: Heritage Line  
 Cover designer: Heritage Line

HO CHI MINH CITY GENERAL PUBLISHING HOUSE  
 62 Nguyen Thi Minh Khai Str, Dist.1, HCMC

Heritage Line

Mailing Address: 33 Le Trung Nghia Street, Ward 12, Tan Binh District, Ho Chi Minh City, Vietnam

Printed in Vietnam, at Dai Phat Printing & Packaging Company  
 Add: 46 Ly Thai To Str., Ward 2, Dist 3, HCMC  
 Publication Registration Confirmed No. 82-2015/CXBIPH/08-05/THTPHCM  
 date 14/01/2015  
 Publication Permit No. 88/QĐ-THTPHCM-2015 date 27/01/2015  
 ISBN: 978-604-58-3471-8  
 Sent to archives: 01/2015

A Heritage Line Collection  
Jayavarman • jasmine • violet • THE JAHAN • Anawrahta  
[www.heritage-line.com](http://www.heritage-line.com)